

► Immersion Range IMM 71/A & 71/B

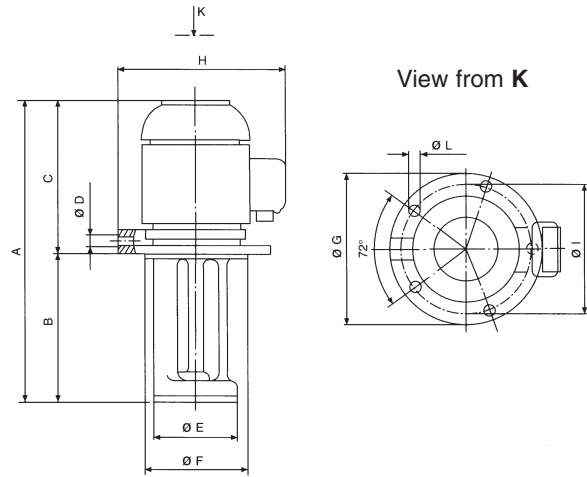
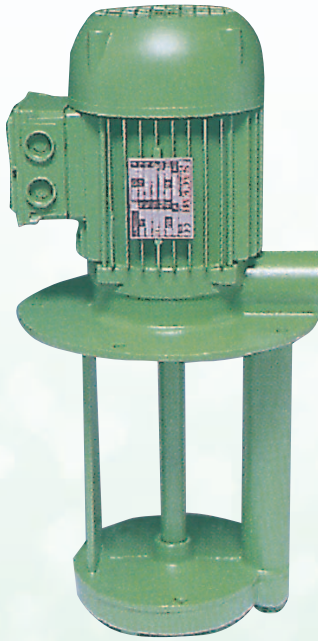

View from K

MECHANICAL FEATURES

Pump Body Cast Aluminium
 Cover Cast Aluminium
 Impeller Bronze
 Shaft Steel

On Request:

Shaft Stainless Steel

MOTOR CHARACTERISTICS

Protection IP55
 Insulation CL. F
 Voltage Eurovoltage 3PH
 Frequency 50Hz

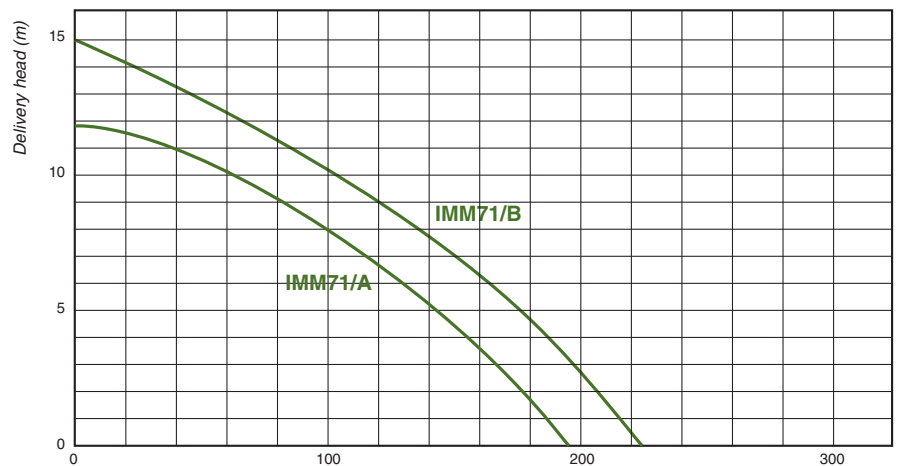

TYPE	KW Absorbed	AMPS 400 V	A mm	B mm	C mm	ØD mm	ØE mm	ØF BSP	ØG BSP	ØH mm	ØI mm	ØL mm	n° L	WEIGHT Kg
IMM 71/A	0.53	1.4	435	200	235	1"	180	190	230	225	204	9	5	9.65
	0.53	1.4	485	250	235	1"	180	190	230	225	204	9	5	9.85
	0.53	1.4	560	325	235	1"	180	190	230	225	204	9	5	10.15
	0.53	1.4	675	440	235	1"	180	190	230	225	204	9	5	10.55
IMM 71/B	0.78	1.9	435	200	235	1"	180	190	230	225	204	9	5	10.85
	0.78	1.9	485	250	235	1"	180	190	230	225	204	9	5	11.05
	0.78	1.9	560	325	235	1"	180	190	230	225	204	9	5	11.35
	0.78	1.9	675	440	235	1"	180	190	230	225	204	9	5	11.80



6 Collins Road Heathcote Industrial Estate Warwick CV34 6TJ U.K.
telephone: 01926 451744 **fax:** 01926 451284
e-mail: sales@pumps-equip.co.uk **web:** www.pumps-equip.co.uk