

# ► SQ RANGE SQ 56/63/71/80

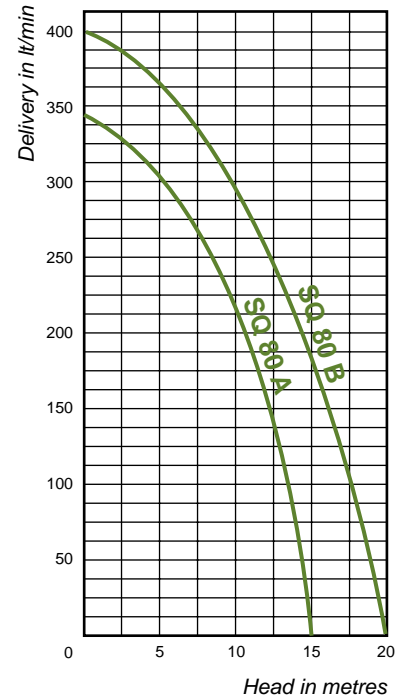

TYPE	KW Absorbed	HP	AMPS 400 V	A mm	B mm	C mm	D mm	E mm	F mm	G mm	ØH mm	ØI	L mm	WEIGHT Kg
SQ 56/S	0.16	0.21	0.55	255	170	60	95	140	75	45	7	3/8" - 1/2"	53	3.87
SQ 63/S	0.30	0.40	0.58	300	180	60	95	158	75	45	7	3/8" - 1/2"	53	5.25
SQ 71/A	0.53	0.71	1.4	330	245	80	145	175	115	60	9	1"	60	14.50
SQ 71/B	0.78	1.04	1.9	330	245	80	145	175	115	60	9	1"	60	15.20
SQ 80/A	1.15	1.54	2.0	335	250	80	145	210	115	60	9	1 1/4"	60	16.30
SQ 80/B	1.47	1.96	2.8	335	250	80	145	210	115	60	9	1 1/4"	60	17.30

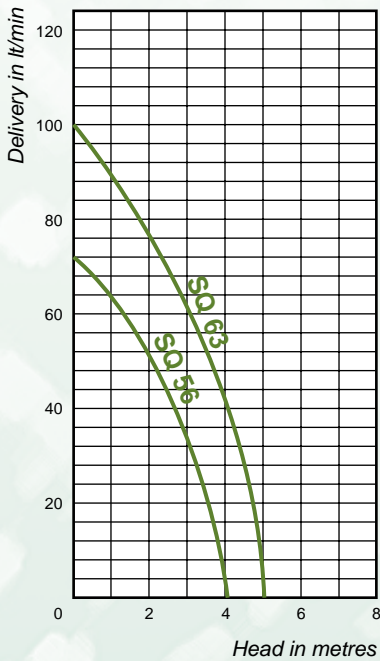
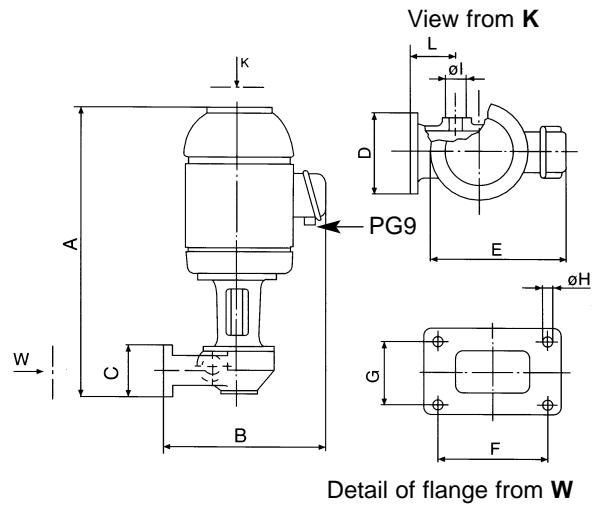

6 Collins Road, Heathcote Industrial Estate, Warwick CV34 6TF United Kingdom.  
**telephone:** 01926 451744 **fax:** 01926 451284  
**e-mail:** sales@pumps-equip.co.uk **web:** www.pumps-equip.co.uk