

## BAL1301...1303

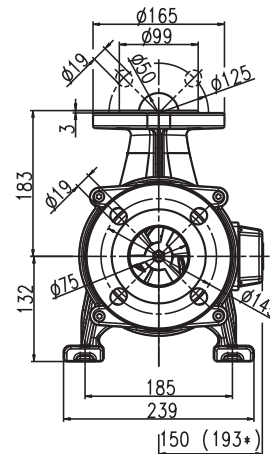

## SBA1301...1303

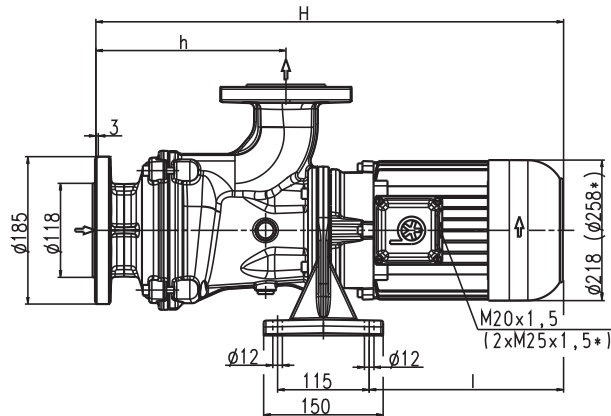
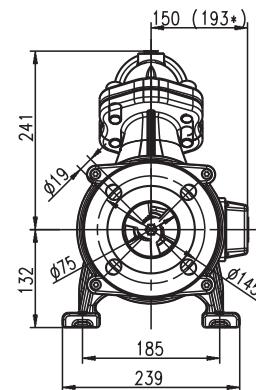
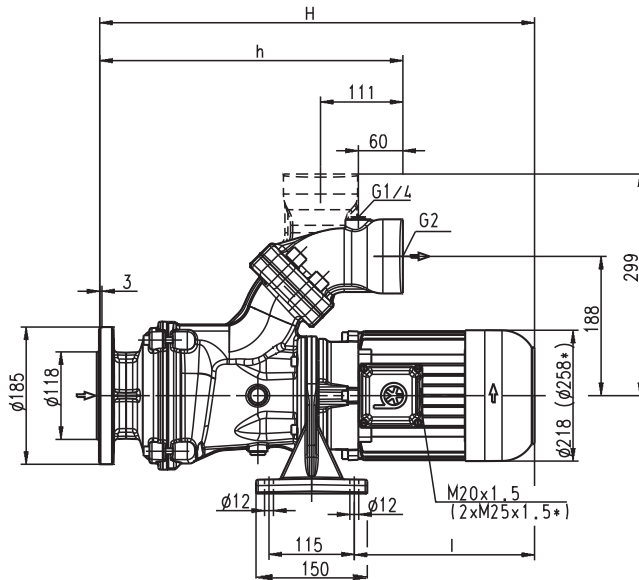

\*) Dimensions for BAL/SBA1302, 1303

Type	Vol. del. at manom. del. head l/min /m	Dimensions H mm	h mm	Length l mm	Weight kg	Power kW	Voltage 3 ~ V	Fre- quency Hz	Rated current A	Speed 1/min
<b>BAL1301</b>	900/12	640	243	293	58	4.0	220-240	50	16.5	2900
<b>SBA1301</b>			412	61						
<b>BAL1302</b>	900/24	794	323	367	96					
<b>SBA1302</b>			492	99						
<b>BAL1303</b>	900/35	923	403	416	116	10.0	220-240	50	40	2900
<b>SBA1303</b>			572	119						
							460	60	23	3450

# Horizontal end-suction pumps

## Axial/semi-open impellers

# BAL/SBA1301-1303

### Horizontal End-Suction Pumps

are centrifugal inline pumps with a compact design where the impeller is mounted onto the extended motor shaft.

These pumps are not self-priming and must be gravity fed. All pumps are equipped with a single mechanical seal.

Upon request a second mechanical seal is available to allow for dry-running (-GD).

This pump series is designed for horizontal installations next to a tank and for pumping **air entrained coolant** fluids, such as **water-soluble coolants or cutting oils**, as they occur in **high speed turning, milling or grinding applications**.

The SBA pumps are equipped with the user-friendly 45 degree **flange** connection which allows for either vertical or horizontal pipe connection and the connection of a pressure gauge with G ¼.

For more information see mechanical features within the technical information section.

### Applications

Types of fluid  
 water  
 coolants  
 cooling/cutting oils  
 Kinematic viscosity  
 ...45 mm<sup>2</sup>/s (45 cSt)  
 Pumping temperature  
 0...80° C

### Construction

Pump body	cast iron
Cover	cast iron
Impeller axial	cast steel
Impeller radial	cast steel
Shaft	steel
Mechanical seal	SiC
Noise level	
BAL1301...SBA1301	71 dBA
BAL1302...SBA1303	74 dBA

