

## BGL1101...1103

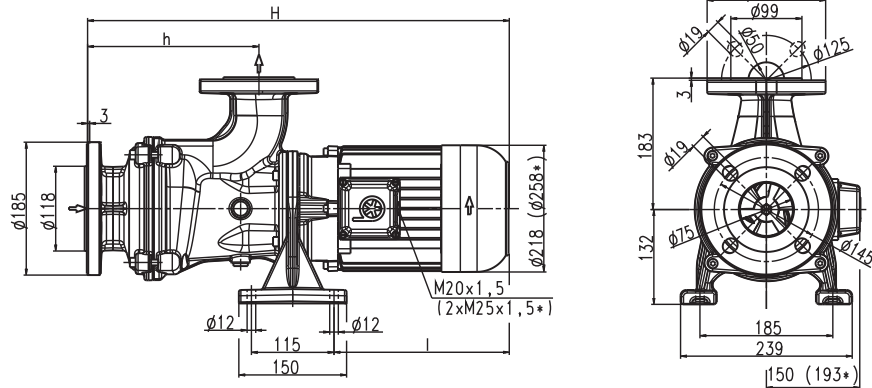

## SBG1101...1103

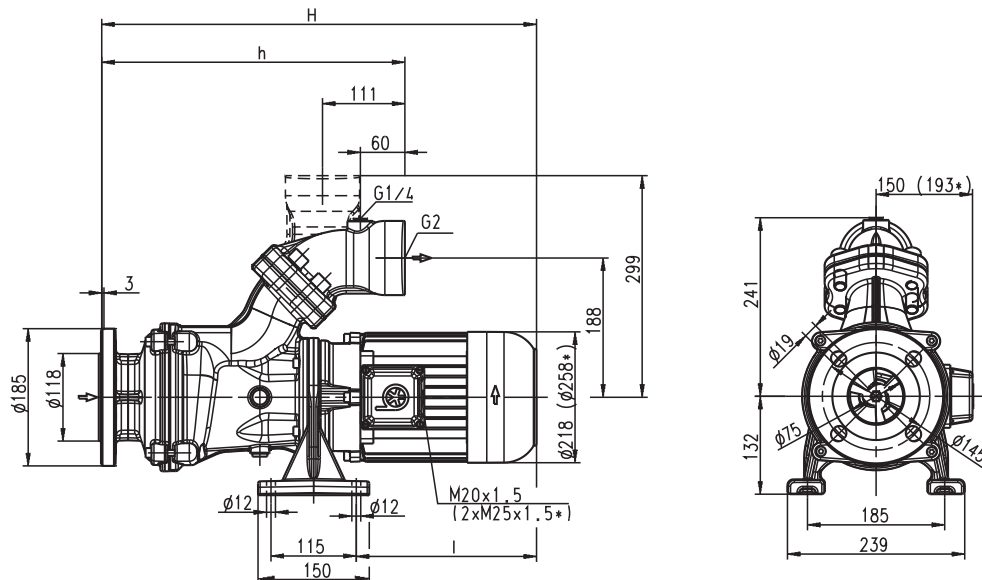

\*) Dimensions for BGL/SBG1102, 1103

Type	Vol. del. at manom. del. head l/min / m	Dimensions H mm	h mm	Length l mm	Weight kg	Power kW	Voltage 3 ~ V	Fre- quency Hz	Rated current A	Speed 1/min
<b>BGL1101</b>	900/12	640	243	293	58	4.0	220-240	50	16.5	2900
<b>SBG1101</b>			412		60		380-420	50	9.5	2900
							460	60	9.5	3450
<b>BGL1102</b>	900/21	794	323	367	106	7.5	220-240	50	29	2900
<b>SBG1102</b>			492		109		380-420	50	17	2900
							460	60	17	3450
<b>BGL1103</b>	900/29	923	403	416	114	10.0	220-240	50	40	2900
<b>SBG1103</b>			572		117		380-420	50	23	2900
							460	60	23	3450



# Horizontal end-suction pumps

## Axial/semi-open impellers

# BGL/SBG1101-1103

### Horizontal End-Suction Pumps

are centrifugal inline pumps with a compact design where the impeller is mounted onto the extended motor shaft. These pumps are not self-priming and must be gravity fed. All pumps are equipped with a single mechanical seal. Upon request a second mechanical seal is available to allow for dry-running (-GD). This pump series is designed for horizontal installations next to a tank and for pumping **highly air entrained coolant and cutting oils**, as they occur in **high speed grinding applications**. The SBG pumps are equipped with the user-friendly 45 degree **flange** connection which allows for either vertical or horizontal pipe connection and the connection of a pressure gauge with G 1/4. For more information see mechanical features within the technical information section.

### Applications

Types of fluid  
 water  
 coolants  
 cooling/cutting oils  
 grinding oils  
 Kinematic viscosity  
 ...45 mm<sup>2</sup>/s (45 cSt)  
 Pumping temperature  
 0...80° C

### Construction

Pump body	cast iron
Cover	cast iron
Impeller axial	cast steel
Impeller radial	cast steel
Shaft	steel
Mechanical seal	SiC
Noise level	
BGL1101...SBG1101	72 dBA
BGL1102...SBG1103	75 dBA

