

Horizontal end-suction pumps

Axial/semi-open impellers

SBA401-403

SBA401...403

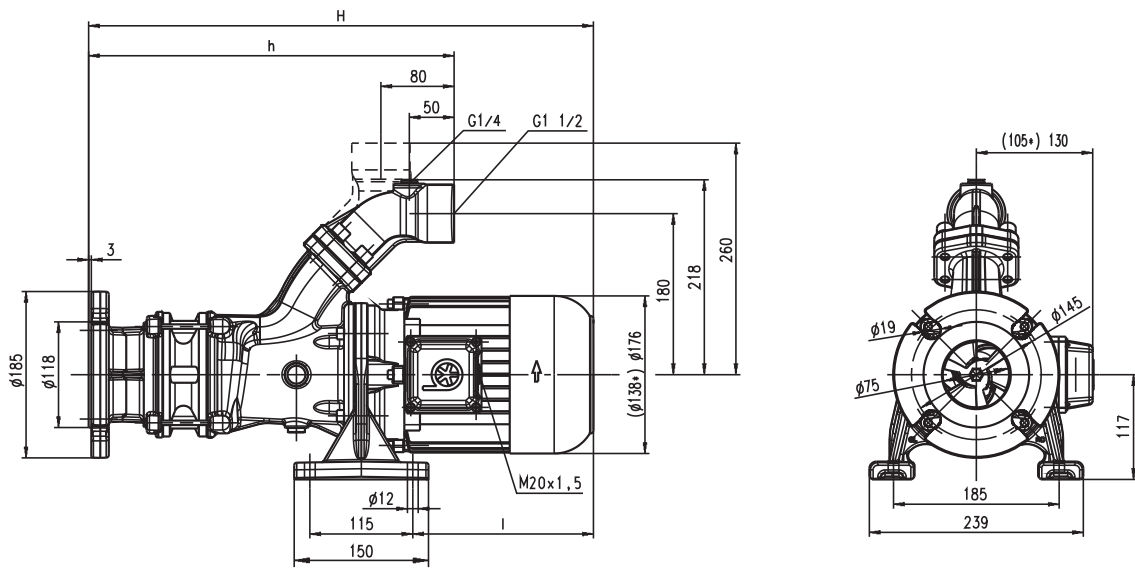

*) Dimensions for SBA401

Type	Vol. del. at manom. del. head l/min /m	Dimensions H mm	h mm	Length l mm	Weight kg	Power kW	Voltage 3~ V	Fre- quency Hz	Rated current A	Speed 1/min
SBA401	200/6	474	359	161	25	0.85	220-240	50	4.3	2800
							380-420	50	2.5	2800
							460	60	2.5	3300
SBA402	200/14	565	408	203	39	1.3	220-240	50	5.2	2850
							380-420	50	3.0	2850
							460	60	3.0	3400
SBA403	200/20	614	457	203	41	1.7	220-240	50	7.1	2850
							380-420	50	4.1	2850
							460	60	4.1	3400



Horizontal end-suction pumps

Axial/semi-open impellers

SBA401-403

Horizontal End-Suction Pumps

are centrifugal inline pumps with a compact design where the impeller is mounted onto the extended motor shaft.

These pumps are not self-priming and must be gravity fed. All pumps are equipped with a single mechanical seal.

Upon request a second mechanical seal is available to allow for dry-running (-GD).

This pump series is designed for horizontal installations next to a tank and for pumping **air entrained coolant fluids**, such as **water-soluble coolants or cutting oils**, as they occur in **high speed turning, milling or grinding applications**.

The SBA pumps are equipped with the user-friendly **(SAE) flange** connection which allows for either vertical or horizontal pipe connection and the connection of a pressure gauge with G 1/4.

For more information see mechanical features within the technical information section.



Applications

Types of fluid
 water
 coolants
 cooling/cutting oils
 Kinematic viscosity
 ...45 mm²/s (45 cSt)
 Pumping temperature
 0...80° C

Construction

Pump body	cast iron
Cover	cast iron
Impeller axial	cast steel
Impeller radial	cast steel
Shaft	steel
Mechanical seal	SiC
Noise level	
SBA401	62 dBA
SBA402...SBA403	66 dBA

