

2-pole motor rotation speed 3500 RPM							4-pole motor rotation speed 1750 RPM					
Pressure max.	Flow at viscosity		Power consumption at viscosity		Motor	Weight	Flow at viscosity		Power consumption at viscosity		Motor	Weight
	1 mm ² /s	20 mm ² /s	1 mm ² /s	20 mm ² /s			1 mm ² /s	20 mm ² /s	1 mm ² /s	20 mm ² /s		
Type / bar	l/min	l/min	kW	kW	kW	kg	l/min	l/min	kW	kW	kW	kg
TFS 574/	Q_{Th}¹⁾ 291.6 –		–	–	–	–	Q_{Th}¹⁾ 145.8 –		–	–	–	–
10	280	284	6.2	7.0	8.6	125	134	139	2.9	3.4	4.6	105
20	276	282	11.0	12.1	17.3	153	130	136	5.4	6.0	6.3	114
30	272	279	15.9	17.2	21.3	173	126	133	7.8	8.5	12.6	152
40	269	277	20.7	22.2	24.5	202	123	131	10.2	11.1	12.6	152
50	266	274	25.6	27.3	33.5	259	120	129	12.6	13.7	17.3	178
60	262	272	30.5	32.4	33.5	259	117	126	15.1	16.2	17.3	178
70	260	270	35.3	37.5	41.5	288	114	124	17.5	18.8	21.3	197
80	257	268	40.2	42.6	51.0	403	111	122	19.9	21.4	24.5	217
90	254	266	45.0	47.7	51.0	403	–	121	–	23.9	24.5	217
100	252	265	49.9	52.7	62.0	498	–	119	–	26.5	33.5	273
110	–	263	–	57.8	62.0	498	–	117	–	29.1	33.5	273
120	–	261	–	62.9	84.0	608	–	116	–	31.6	33.5	273
TFS 5100/	Q_{Th}¹⁾ 394.1 –		–	–	–	–	Q_{Th}¹⁾ 197.0 –		–	–	–	–
10	378	384	7.9	8.7	12.6	144	181	187	3.8	4.3	6.3	114
20	374	381	14.4	15.6	21.3	173	177	184	7.1	7.8	8.6	129
30	370	377	21.0	22.6	24.5	202	173	180	10.4	11.3	12.6	152
40	366	374	27.6	29.5	33.5	259	169	177	13.6	14.8	17.3	178
50	362	372	34.1	36.4	41.5	288	165	174	16.9	18.3	21.3	197
60	358	369	40.7	43.4	51.0	403	161	172	20.2	21.8	24.5	217
70	355	367	47.3	50.3	62.0	498	158	170	23.5	25.3	33.5	273
80	351	364	53.8	57.3	62.0	498	154	167	26.8	28.8	33.5	273
90	348	362	60.4	64.2	84.0	608	–	165	–	32.3	33.5	273
100	345	361	67.0	71.1	84.0	608	–	164	–	35.8	41.5	363
110	–	359	–	78.1	84.0	608	–	162	–	39.3	41.5	363
120	–	358	–	85.0	101	693	–	161	–	42.8	51.0	403

¹⁾ Q_{Th}: Theoretical flow rate



High pressure pumps

Screw spindles

TFS/FFS 574 - 5100

60 Hz

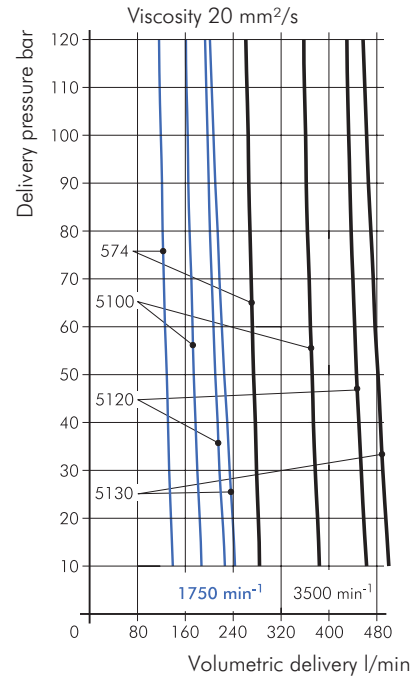
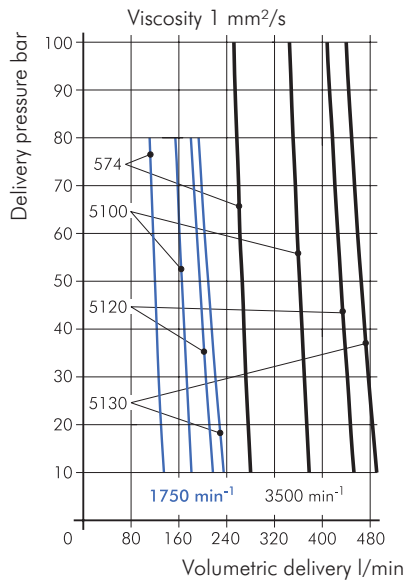
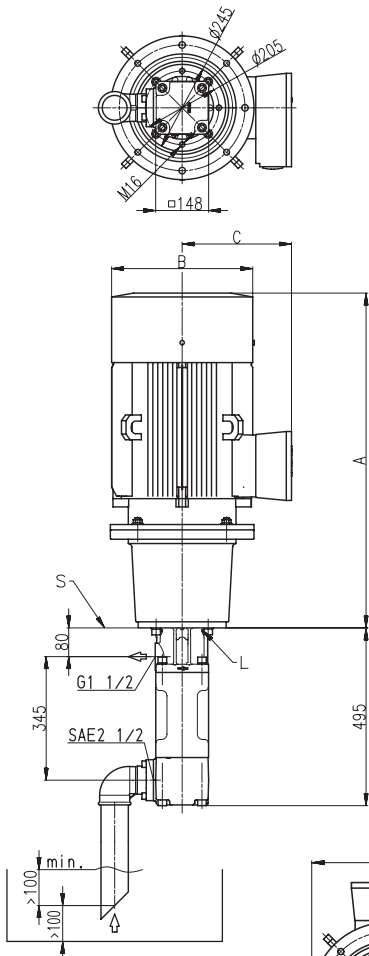

L = Leakage hole
S = Mounting plate, please find the cut-out of mounting hole on page 43.

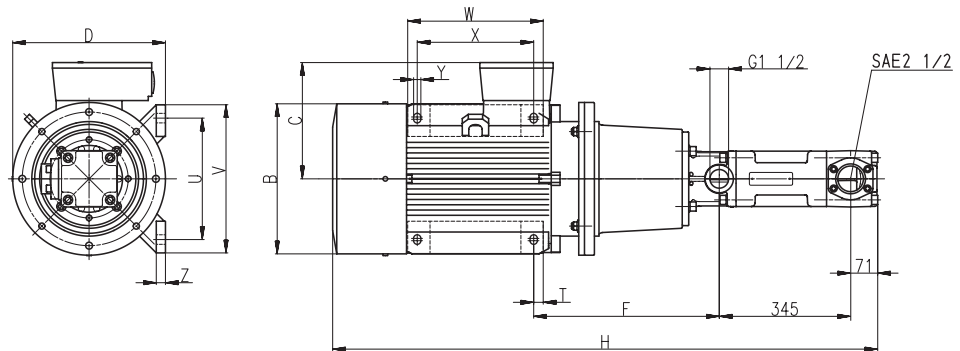

For mounting patterns of foot-mounted motors smaller than 45 kW please refer to page 33.

Motor 2 pole kW	Motor 4 pole kW	A	B	C	D	E	F	H	T	U	V	W	X	Y	Z
		mm	mm	mm	mm	mm	mm	mm	mm	mm	mm	mm	mm	mm	mm
-	4.6	562	227	148	280	218	179	990	22.5	215	250	230	185	14	15
-	6.3	583	267	167	335	248	185	1076	22.5	265	300	270	225	14	18
8.6	8.6	659	267	197	335	248	185	1152	22.5	265	300	270	225	14	18
12.6 / 17.3	12.6	748	320	197	410	298	225	1244	20.0	300	350	305	265	18	18
21.3	17.3	828	320	197	410	298	225	1324	20.0	300	350	305	265	18	18
24.5	21.3 / 24.5	872	363	258	410	298	225	1368	20.0	300	350	305	265	18	18
33.5 / 41.5	33.5	931	402	305	400	263	473	1427	25.0	318	398	355	305	25	34
-	41.5	967	442	328	450	288	531	1473	37.0	356	436	361	286	25	34
51	-	973	442	328	450	288	531	1479	37.0	356	436	361	286	25	34
-	51	1027	442	328	450	288	531	1533	37.0	356	436	361	286	25	34
62	-	1093	505	392	525	313	560	1589	30.0	406	506	409	349	30	42
84	-	1251	555	432	555	280	607	1749	30.0	457	557	479	419	30	42
101	-	1361	555	432	555	280	607	1859	30.0	457	557	479	419	30	42

