

High pressure pumps

Screw spindles

TFS/FFS 574 - 5100

50 Hz

2-pole motor rotation speed 2900 RPM							4-pole motor rotation speed 1450 RPM					
Pressure max.	Flow at viscosity		Power consumption at viscosity		Motor	Weight	Flow at viscosity		Power consumption at viscosity		Motor	Weight
	1 mm ² /s	20 mm ² /s	1 mm ² /s	20 mm ² /s			1 mm ² /s	20 mm ² /s	1 mm ² /s	20 mm ² /s		
Type / bar	l/min	l/min	kW	kW	kW	kg	l/min	l/min	kW	kW	kW	kg
TFS 574/	Q_{Th}¹⁾ 241.6	–	–	–	–	–	Q_{Th}¹⁾ 120.8	–	–	–	–	–
10	230	234	5.0	5.7	7.5	125	109	114	2.3	2.7	4.0	105
20	226	232	9.1	9.9	11.0	144	105	111	4.3	4.8	5.5	114
30	222	229	13.1	14.2	15.0	153	101	108	6.3	7.0	7.5	129
40	219	227	17.1	18.4	22.0	202	98	106	8.4	9.1	11.0	152
50	216	224	21.1	22.6	30.0	259	95	104	10.4	11.3	15.0	178
60	213	222	25.2	26.9	30.0	259	92	101	12.4	13.4	15.0	178
70	210	220	29.2	31.1	37.0	288	89	99	14.4	15.5	18.5	197
80	207	218	33.2	35.4	37.0	288	86	97	16.4	17.7	18.5	197
90	204	216	37.2	39.6	45.0	403	–	96	–	19.8	22.0	217
100	202	215	41.3	43.8	45.0	403	–	94	–	21.9	22.0	217
110	–	213	–	48.1	55.0	498	–	–	–	–	–	–
120	–	211	–	52.3	55.0	498	–	–	–	–	–	–
TFS 5100/	Q_{Th}¹⁾ 326.5	–	–	–	–	–	Q_{Th}¹⁾ 163.3	–	–	–	–	–
10	310	317	6.4	7.1	11.0	144	147	153	3.0	3.5	5.5	114
20	306	313	11.9	12.9	15.0	153	143	150	5.7	6.4	7.5	129
30	302	310	17.3	18.6	22.0	202	139	147	8.5	9.3	11.0	152
40	298	307	22.8	24.4	30.0	259	135	144	11.2	12.2	15.0	178
50	294	304	28.2	30.2	37.0	288	131	141	13.9	15.1	18.5	197
60	291	301	33.7	36.0	37.0	288	127	138	16.6	18.0	18.5	197
70	287	299	39.1	41.7	45.0	403	124	136	19.3	20.9	22.0	217
80	284	297	44.5	47.5	55.0	498	120	134	22.1	23.9	30.0	273
90	280	295	50.0	53.3	55.0	498	–	132	–	26.8	30.0	273
100	277	293	55.4	59.1	75.0	608	–	130	–	29.7	30.0	273
110	–	292	–	64.8	75.0	608	–	–	–	–	–	–
120	–	291	–	70.6	75.0	608	–	–	–	–	–	–

¹⁾ Q_{Th}: Theoretical flow rate



High pressure pumps

Screw spindles

TFS/FFS 574 - 5100

50 Hz

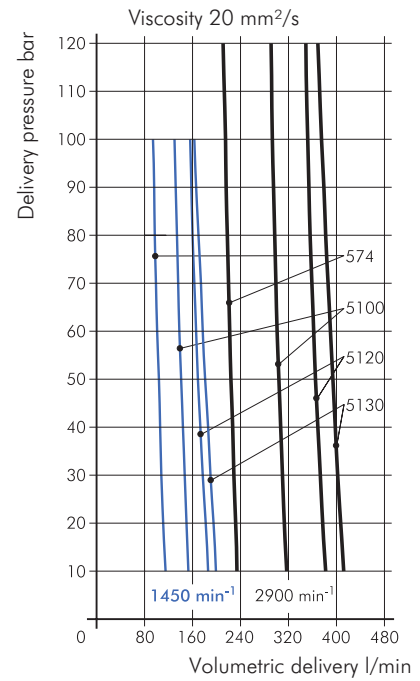
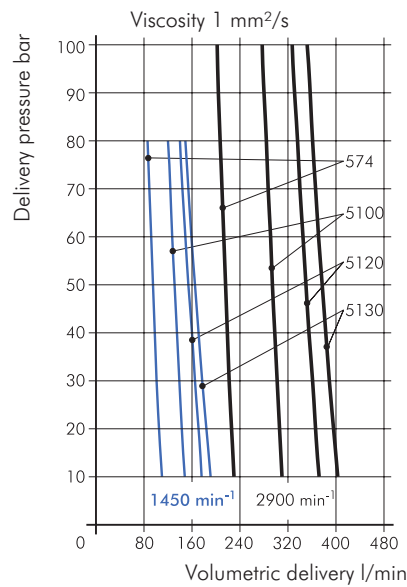
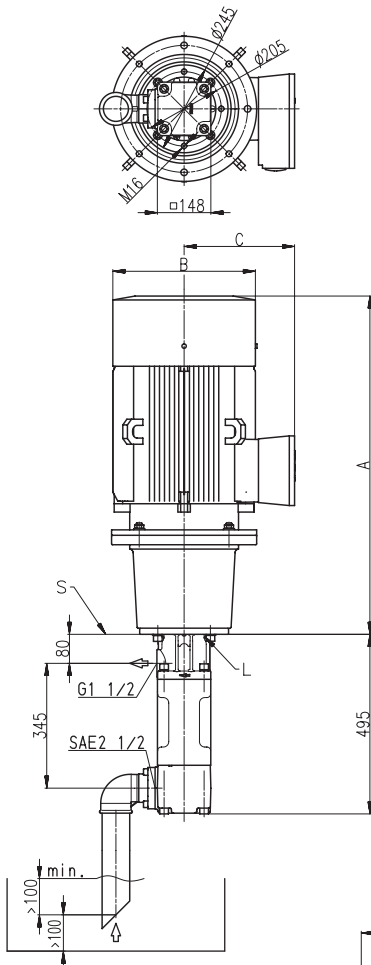

L = Leakage hole
S = Mounting plate, please find the cut-out of mounting hole on page 43.

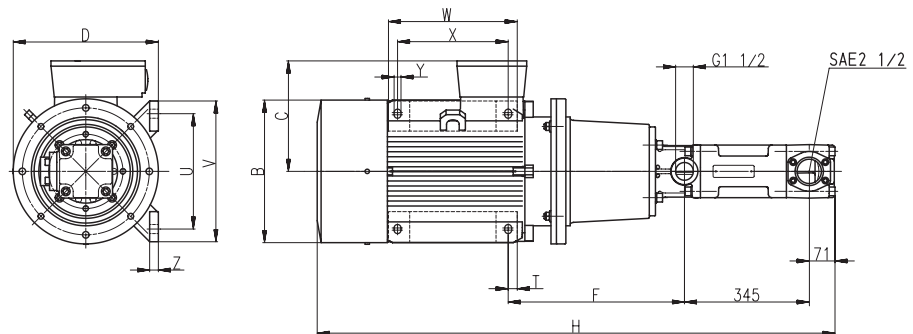

For mounting patterns of foot-mounted motors smaller than 45 kW please refer to page 19.

Motor 2 pole kW	Motor 4 pole kW	A	B	C	D	E	F	H	T	U	V	W	X	Y	Z
		mm	mm	mm	mm	mm	mm	mm	mm	mm	mm	mm	mm	mm	mm
-	4.0	562	227	148	280	218	179	990	22.5	215	250	230	185	14	15
-	5.5	583	267	167	335	248	185	1076	22.5	265	300	270	225	14	18
7.5	7.5	659	267	197	335	248	185	1152	22.5	265	300	270	225	14	18
11.0 / 15.0	11.0	748	320	197	410	298	225	1244	20.0	300	350	305	265	18	18
18.5	15.0	828	320	197	410	298	225	1324	20.0	300	350	305	265	18	18
22.0	18.5 / 22.0	872	363	258	410	298	225	1368	20.0	300	350	305	265	18	18
30.0 / 37.0	30.0	931	402	305	400	263	473	1427	25.0	318	398	355	305	25	34
45.0	-	973	442	328	450	288	531	1479	37.0	356	436	361	286	25	34
55	-	1093	505	392	525	313	560	1589	30.0	406	506	409	349	30	42
75	-	1251	555	432	555	280	607	1749	30.0	457	557	479	419	30	42
90	-	1361	555	432	555	280	607	1859	30.0	457	557	479	419	30	42

