

# High pressure pumps

## Screw spindles

# TFS/FFS 5120 - 5130

## 60 Hz

2-pole motor rotation speed 3500 RPM							4-pole motor rotation speed 1750 RPM					
Pressure max.	Flow at viscosity		Power consumption at viscosity		Motor	Weight	Flow at viscosity		Power consumption at viscosity		Motor	Weight
	1 mm <sup>2</sup> /s	20 mm <sup>2</sup> /s	1 mm <sup>2</sup> /s	20 mm <sup>2</sup> /s			1 mm <sup>2</sup> /s	20 mm <sup>2</sup> /s	1 mm <sup>2</sup> /s	20 mm <sup>2</sup> /s		
Type / bar	l/min	l/min	kW	kW	kW	kg	l/min	l/min	kW	kW	kW	kg
<b>TFS 5120/</b>	<b>Q<sub>Th</sub><sup>1)</sup> 472.9 –</b>		–	–	–	–	<b>Q<sub>Th</sub><sup>1)</sup> 236.4 –</b>		–	–	–	–
10	453	463	9.2	10.0	17.3	153	217	226	4.4	5.0	6.3	114
20	447	458	17.1	18.4	21.3	173	211	222	8.4	9.2	12.6	152
30	442	454	24.9	26.7	33.5	259	205	217	12.3	13.4	17.3	178
40	436	450	32.8	35.1	41.5	288	200	214	16.3	17.6	21.3	197
50	431	446	40.7	43.5	51.0	403	195	210	20.2	21.8	24.5	217
60	426	443	48.6	51.9	62.0	498	190	207	24.1	26.1	33.5	273
70	421	440	56.5	60.2	62.0	498	185	204	28.1	30.3	33.5	273
80	417	437	64.3	68.6	84.0	608	180	201	32.0	34.5	41.5	363
90	412	435	72.2	77.0	84.0	608	–	199	–	38.7	41.5	363
100	408	433	80.1	85.4	101	693	–	197	–	42.9	51.0	403
110	–	431	–	93.7	101	693	–	195	–	47.1	51.0	403
120	–	430	–	102.1	123	868	–	193	–	51.3	62.0	468
<b>TFS 5130/</b>	<b>Q<sub>Th</sub><sup>1)</sup> 512.3 –</b>		–	–	–	–	<b>Q<sub>Th</sub><sup>1)</sup> 256.1 –</b>		–	–	–	–
10	491	500	9.8	11.7	17.3	153	235	243	4.8	5.4	6.3	114
20	484	495	18.4	20.3	24.5	202	228	239	9.0	10.7	12.6	152
30	477	490	26.9	29.0	33.5	259	221	234	13.3	16.0	17.3	178
40	471	486	35.5	37.6	41.5	288	215	230	17.6	21.3	24.5	217
50	465	482	44.0	46.2	51.0	403	209	225	21.8	26.6	33.5	273
60	459	477	52.5	54.8	62.0	498	203	221	26.1	32.0	33.5	273
70	454	474	61.1	63.5	84.0	608	198	217	30.4	37.3	41.5	363
80	449	470	69.6	72.1	84.0	608	193	214	34.7	42.6	51.0	403
90	444	466	78.1	80.7	84.0	608	–	210	–	47.9	51.0	403
100	440	463	86.7	89.3	101	693	–	207	–	53.2	62.0	468
110	–	460	–	98.0	123	868	–	204	–	58.5	62.0	468
120	–	457	–	106.6	123	868	–	201	–	63.8	84.0	674

<sup>1)</sup> Q<sub>Th</sub>: Theoretical flow rate



# High pressure pumps

## Screw spindles

# TFS/FFS 5120 - 5130

## 60 Hz

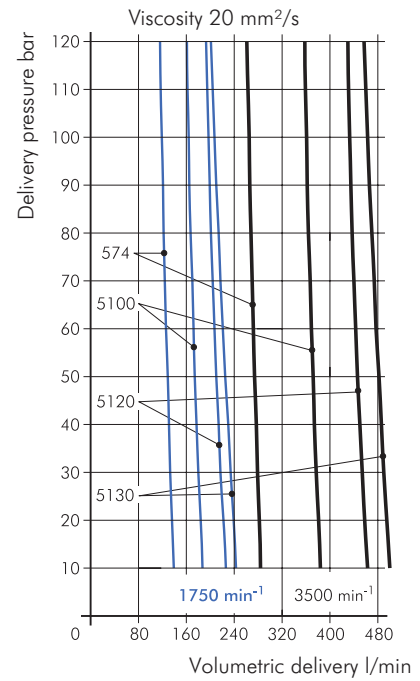
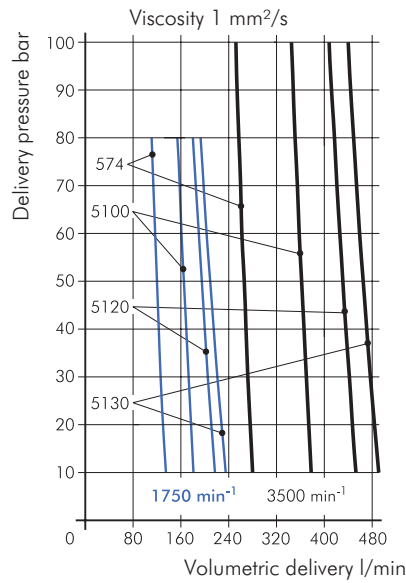
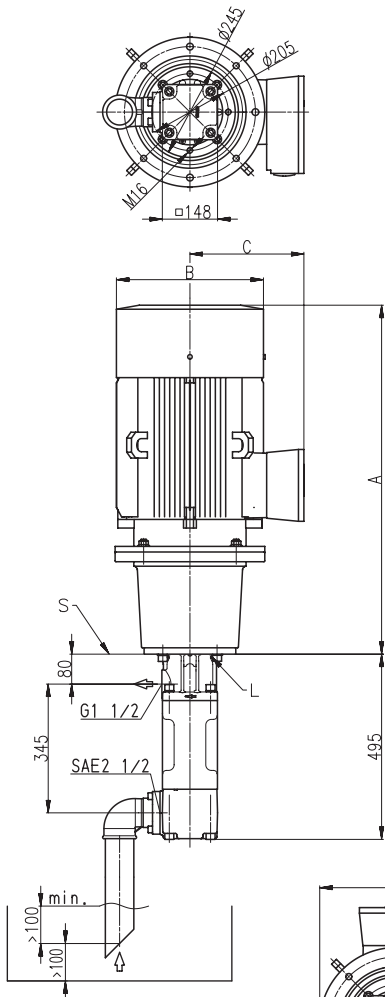

L = Leakage hole  
S = Mounting plate, please find the cut-out of mounting hole on page 43.

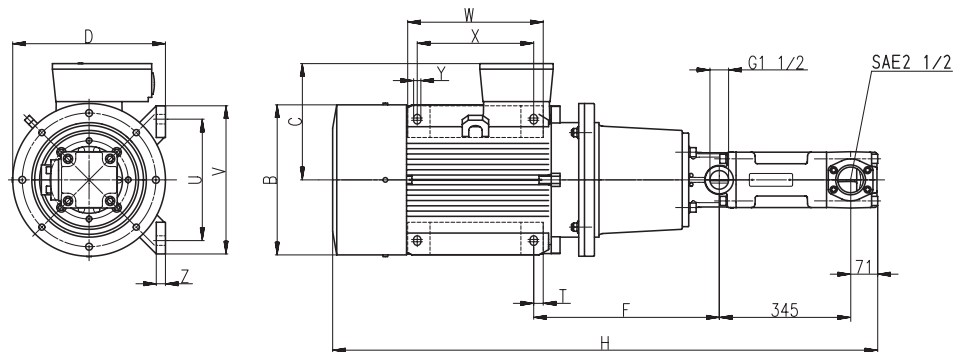

For mounting patterns of foot-mounted motors smaller than 45 kW please refer to page 33.

Motor 2 pole kW	Motor 4 pole kW	A	B	C	D	E	F	H	T	U	V	W	X	Y	Z
		mm	mm	mm	mm	mm	mm	mm	mm	mm	mm	mm	mm	mm	mm
-	6.3	583	267	167	335	248	185	1076	22.5	265	300	270	225	14	18
17.3	12.6	748	320	197	410	298	225	1244	20.0	300	350	305	265	18	18
21.3	17.3	828	320	197	410	298	225	1324	20.0	300	350	305	265	18	18
24.5	21.3 / 24.5	872	363	258	410	298	225	1368	20.0	300	350	305	265	18	18
33.5 / 41.5	33.5	931	402	305	400	263	473	1427	25.0	318	398	355	305	25	34
-	41.5	967	442	328	450	288	531	1473	37.0	356	436	361	286	25	34
51	-	973	442	328	450	288	531	1479	37.0	356	436	361	286	25	34
-	51	1027	442	328	450	288	531	1533	37.0	356	436	361	286	25	34
62	-	1093	505	392	525	313	560	1589	30.0	406	506	409	349	30	42
84	-	1251	555	432	555	280	607	1749	30.0	457	557	479	419	30	42
101	-	1361	555	432	555	280	607	1859	30.0	457	557	479	419	20	42
123	-	1319	621	500	645	378	661	1817	35.0	508	628	527	457	35	52

