

High pressure pumps

Screw spindles

TFS/FFS 5120 - 5130

50 Hz

2-pole motor rotation speed 2900 RPM							4-pole motor rotation speed 1450 RPM					
Pressure max.	Flow at viscosity		Power consumption at viscosity		Motor	Weight	Flow at viscosity		Power consumption at viscosity		Motor	Weight
	1 mm ² /s	20 mm ² /s	1 mm ² /s	20 mm ² /s			1 mm ² /s	20 mm ² /s	1 mm ² /s	20 mm ² /s		
Type / bar	l/min	l/min	kW	kW	kW	kg	l/min	l/min	kW	kW	kW	kg
TFS 5120/	Q_{Th}¹⁾ 391.8	–	–	–	–	–	Q_{Th}¹⁾ 195.9	–	–	–	–	–
10	372	382	7.5	8.7	11.0	144	176	186	3.6	4.1	5.5	114
20	366	377	14.1	15.6	18.5	173	171	181	6.8	7.6	11.0	152
30	361	373	20.6	22.5	30.0	259	165	177	10.1	11.1	15.0	178
40	355	369	27.1	29.5	37.0	288	160	173	13.4	14.6	18.5	197
50	350	365	33.7	36.4	45.0	403	154	169	16.6	18.1	22.0	217
60	345	362	40.2	43.3	45.0	403	149	166	19.9	21.6	22.0	217
70	340	359	46.7	50.2	55.0	498	144	163	23.2	25.1	30.0	273
80	336	356	53.2	57.1	75.0	608	140	160	26.4	28.6	30.0	273
90	331	354	59.8	64.0	75.0	608	–	158	–	32.1	37.0	363
100	327	352	66.3	71.0	75.0	608	–	156	–	35.6	37.0	363
110	–	350	–	77.9	90.0	693	–	–	–	–	–	–
120	–	349	–	84.8	90.0	693	–	–	–	–	–	–
TFS 5130/	Q_{Th}¹⁾ 424.5	–	–	–	–	–	Q_{Th}¹⁾ 212.2	–	–	–	–	–
10	403	412	8.1	9.2	11.0	144	191	199	3.8	4.3	5.5	114
20	396	407	15.1	16.5	18.5	173	184	195	7.4	8.0	11.0	152
30	389	402	22.2	23.7	30.0	259	177	190	10.9	11.7	15.0	178
40	383	398	29.3	31.0	37.0	288	171	186	14.4	15.3	18.5	197
50	377	394	36.4	38.3	45.0	403	165	181	18.0	19.0	22.0	217
60	371	390	43.4	45.6	55.0	498	159	177	21.5	22.7	30.0	273
70	366	386	50.5	52.8	55.0	498	154	174	25.1	26.4	30.0	273
80	361	382	57.6	60.1	75.0	608	149	170	28.6	30.0	37.0	363
90	357	379	64.7	67.4	75.0	608	–	166	–	33.7	37.0	363
100	352	375	71.7	74.7	90.0	693	–	163	–	37.4	45.0	403
110	–	372	–	81.9	90.0	693	–	–	–	–	–	–
120	–	369	–	89.2	90.0	693	–	–	–	–	–	–

¹⁾ Q_{Th}: Theoretical flow rate



High pressure pumps

Screw spindles

TFS/FFS 5120 - 5130

50 Hz

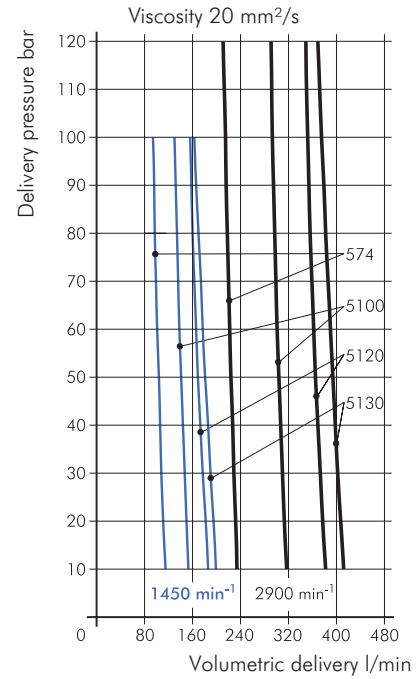
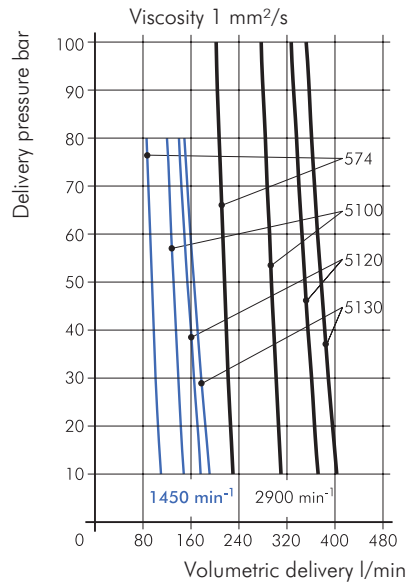
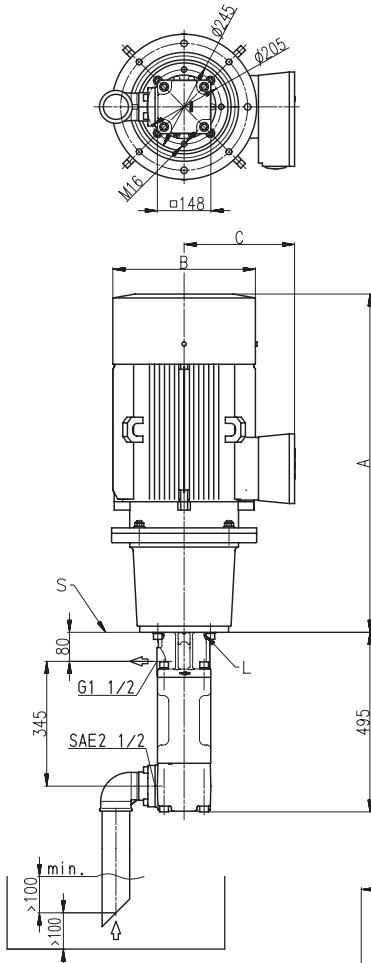

L = Leakage hole
S = Mounting plate, please find the cut-out of mounting hole on page 43.

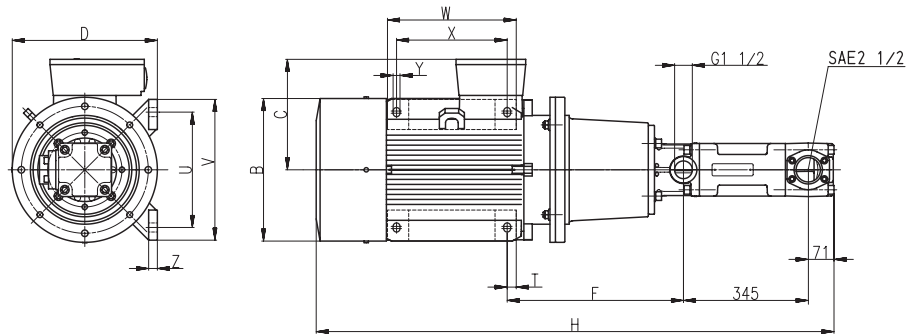

For mounting patterns of foot-mounted motors smaller than 45 kW please refer to page 19.

Motor 2 pole kW	Motor 4 pole kW	A	B	C	D	E	F	H	T	U	V	W	X	Y	Z
		mm	mm	mm	mm	mm	mm	mm	mm	mm	mm	mm	mm	mm	mm
-	5.5	583	267	167	335	248	185	1076	22.5	265	300	270	225	14	18
7.5	7.5	659	267	197	335	248	185	1152	22.5	265	300	270	225	14	18
11.0 / 15.0	11.0	748	320	197	410	298	225	1244	20.0	300	350	305	265	18	18
18.5	15.0	828	320	197	410	298	225	1324	20.0	300	350	305	265	18	18
22.0	18.5 / 22.0	872	363	258	410	298	225	1368	20.0	300	350	305	265	18	18
30.0 / 37.0	30.0	931	402	305	400	263	473	1427	25.0	318	398	355	305	25	34
-	37.0	967	442	328	450	288	531	1473	37.0	356	436	361	286	25	34
45.0	-	1027	442	328	450	288	531	1533	37.0	356	436	361	286	25	34
-	45.0	1027	442	328	450	288	531	1533	37.0	356	436	361	286	25	34
55	-	1093	505	392	525	313	560	1589	30.0	406	506	409	349	30	42
75	-	1251	555	432	555	280	607	1749	30.0	457	557	479	419	30	42
90	-	1361	555	432	555	280	607	1859	30.0	457	557	479	419	30	42

